

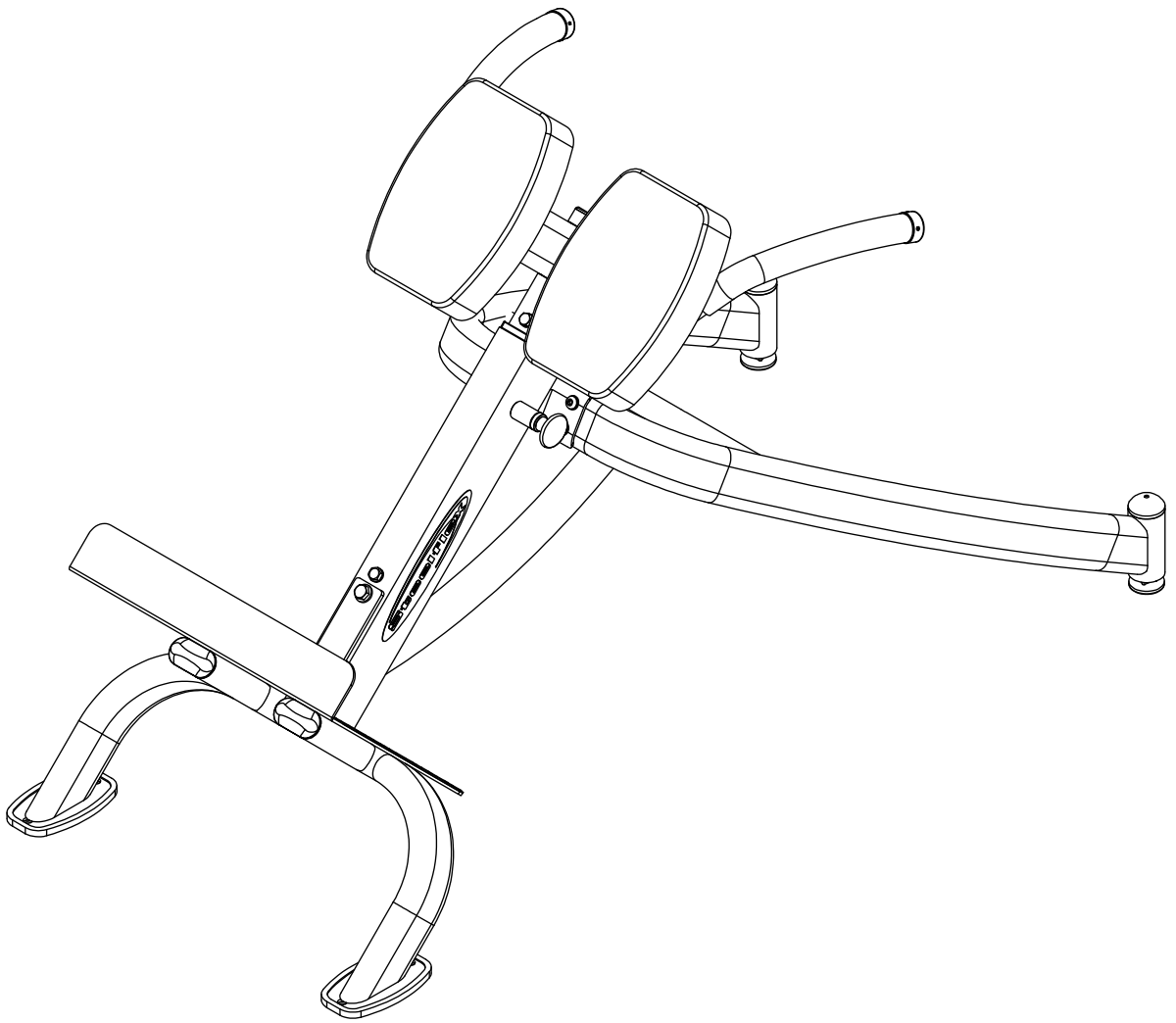

*NBE.5*



Assembly & Instructions

**OWNER'S & MANUAL**

**NBE.5 HARDWARE**

(shown in actual size)

A1.M12X115 HEX HEAD SCREW.....[2PCS]

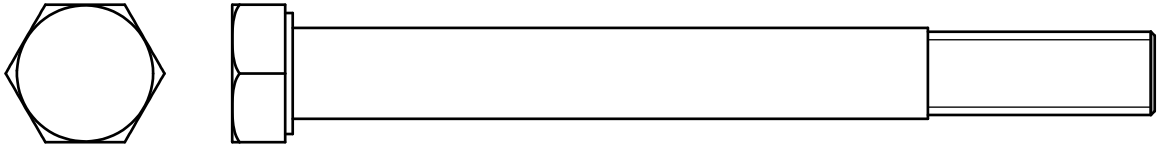

A2.M10X65 ALLEN SCREW.....[4PCS]

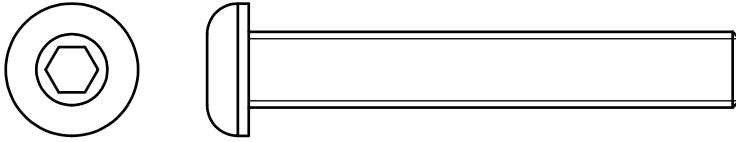

A3.M10X25 ALLEN SCREW.....[2PCS]

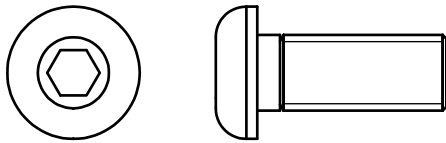

A4.M8X25 HEX ALLEN SCREW.....[4PCS]

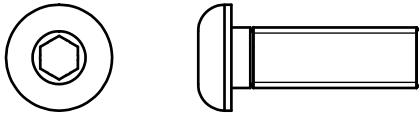

A5.M8X16 TAPER SCREW(FULL THREAD).....[4PCS]

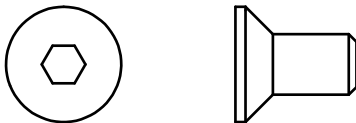

A6.M5X5 GRUB SCREW (pre-installed).....[4PCS]



A7.M10X100 HEX HEAD SCREW (pre-installed).....[1PCS]

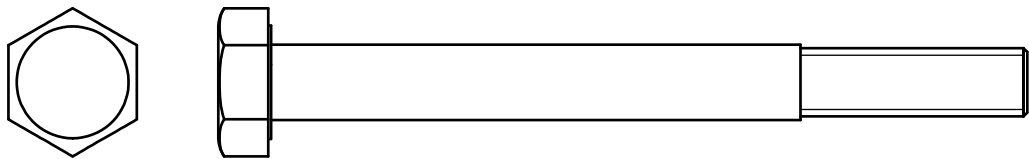

A8.M10X90 HEX HEAD SCREW (pre-installed).....[1PCS]

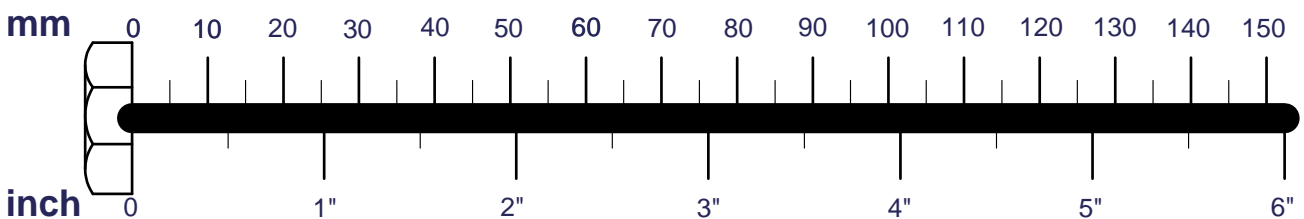
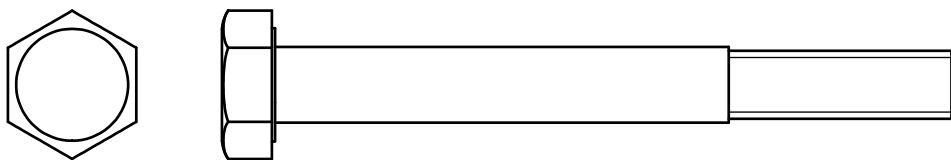

**NBE.5 HARDWARE**  
(shown in actual size)

**B1.M12 NYLON LOCK NUT**  
...[2PCS]

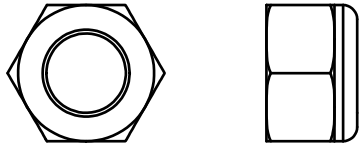

**B2.M10 Plate NUT...**[4PCS]

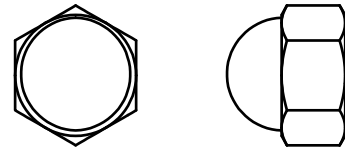

**B3.M12 LOCK NUT ...**[2PCS]

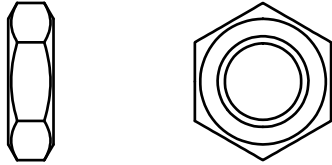

**B4.M10 NYLON LOCK NUT**  
(pre-installed) ...[2PCS]

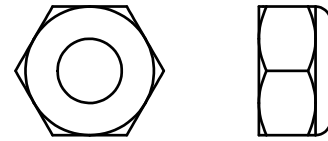

**C2.M12 WASHER(Ø25)...**[4PCS]

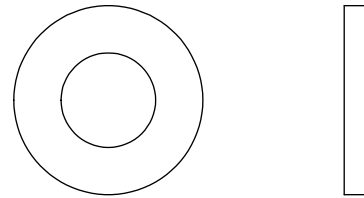

**C3.M10 WASHER (Ø19)...**[12PCS]  
(pre-installed...4PCS)

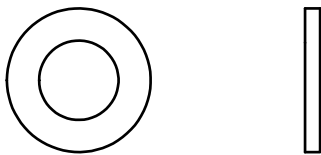

**C4.M10 SPRING WASHER...**[2PCS]

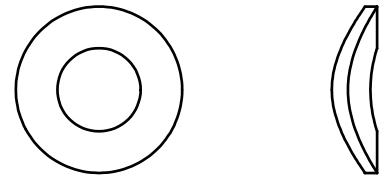

**C5.M8 WASHER ...**[4PCS]

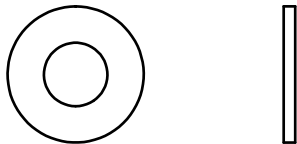

**C6.M8 SPRING WASHER ...**[4PCS]

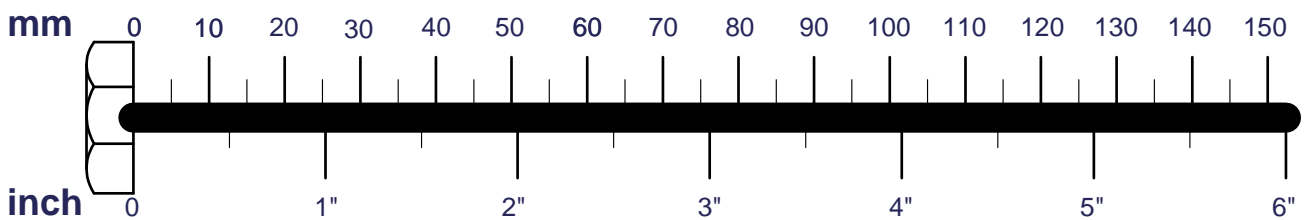

**NBE.5 HARDWARE**  
(shown in actual size)

A[1PCS]

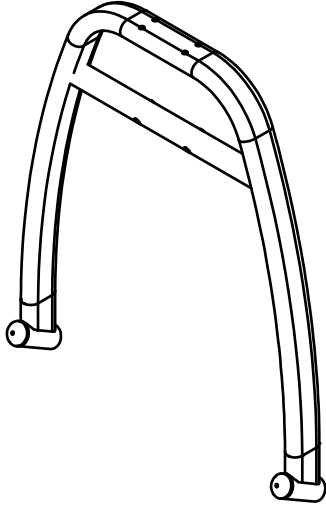

B[1PCS]

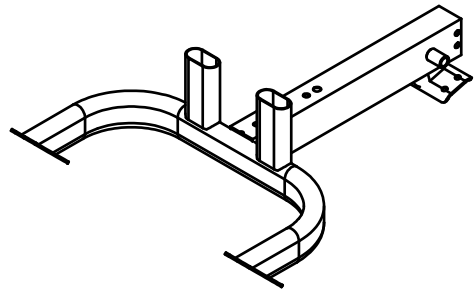

C[1PCS]

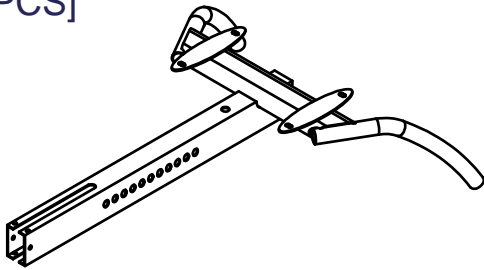

D[1PCS]

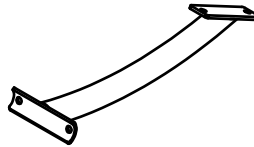

E[1PCS]

8370-056

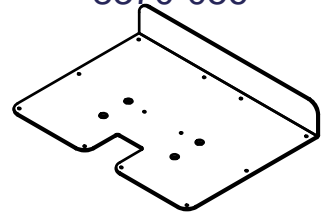

F[1PCS]  
8323-173

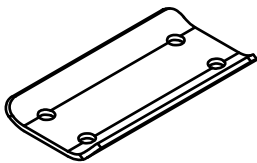

G[1PCS]  
8312-067

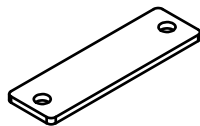

M[2PCS]  
9131-049

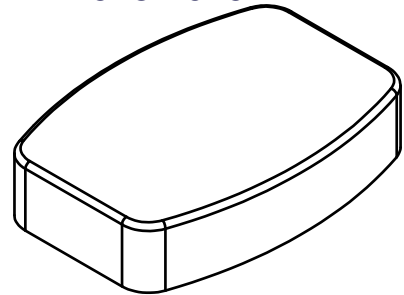

N[1PCS]  
8830-037  
pre-installed

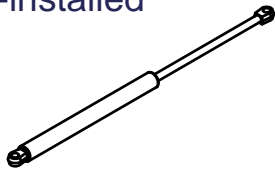

**NBE.5 HARDWARE**  
(shown in actual size)

D2.Ø31.8" Round End Cap (9211-169)	—————	2PCS
D3.40X80 End Cap (9211-191)	—————	2PCS
D4.□50X75 End Cap (9211-012)	—————	1PCS
D5.94X164L Rubber Pad (9310-076)	—————	2PCS
D6.□75X82.5 Rubber Bushing (9211-178) pre-installed	—————	1PCS
D7.Impregnated with handle (9162-149) pre-installed	—————	2PCS
D8.Chrome Collar (8890-048) pre-installed	—————	2PCS
D9.Rubber dount (9214-045)	—————	2PCS
D10.The iron sleeve (8110-135) pre-installed	—————	2PCS
D11.POP PIN (8250-065G) pre-installed	—————	1PCS
D12. D10.The iron sleeve (8110-134) pre-installed	—————	2PCS
D13. Round End Cap (9211-177) pre-installed	—————	6PCS

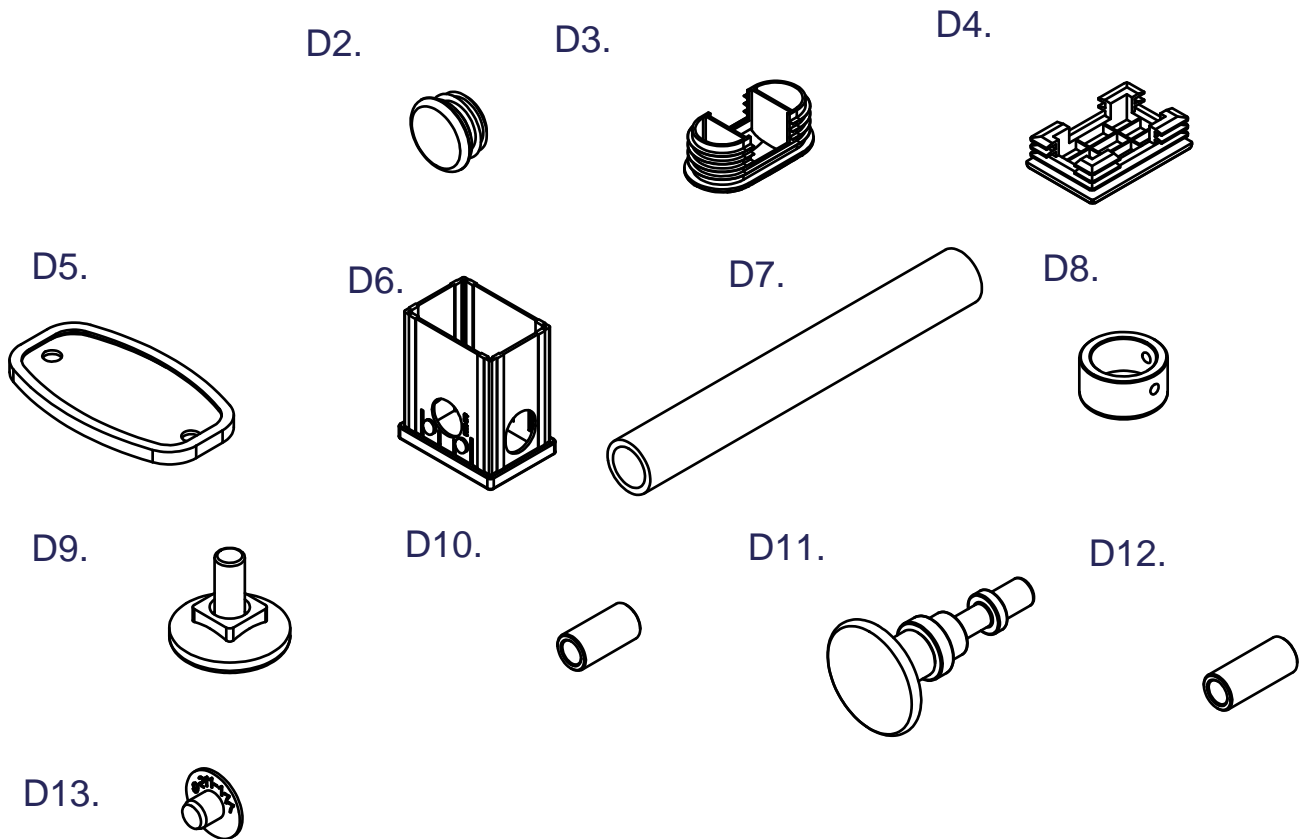

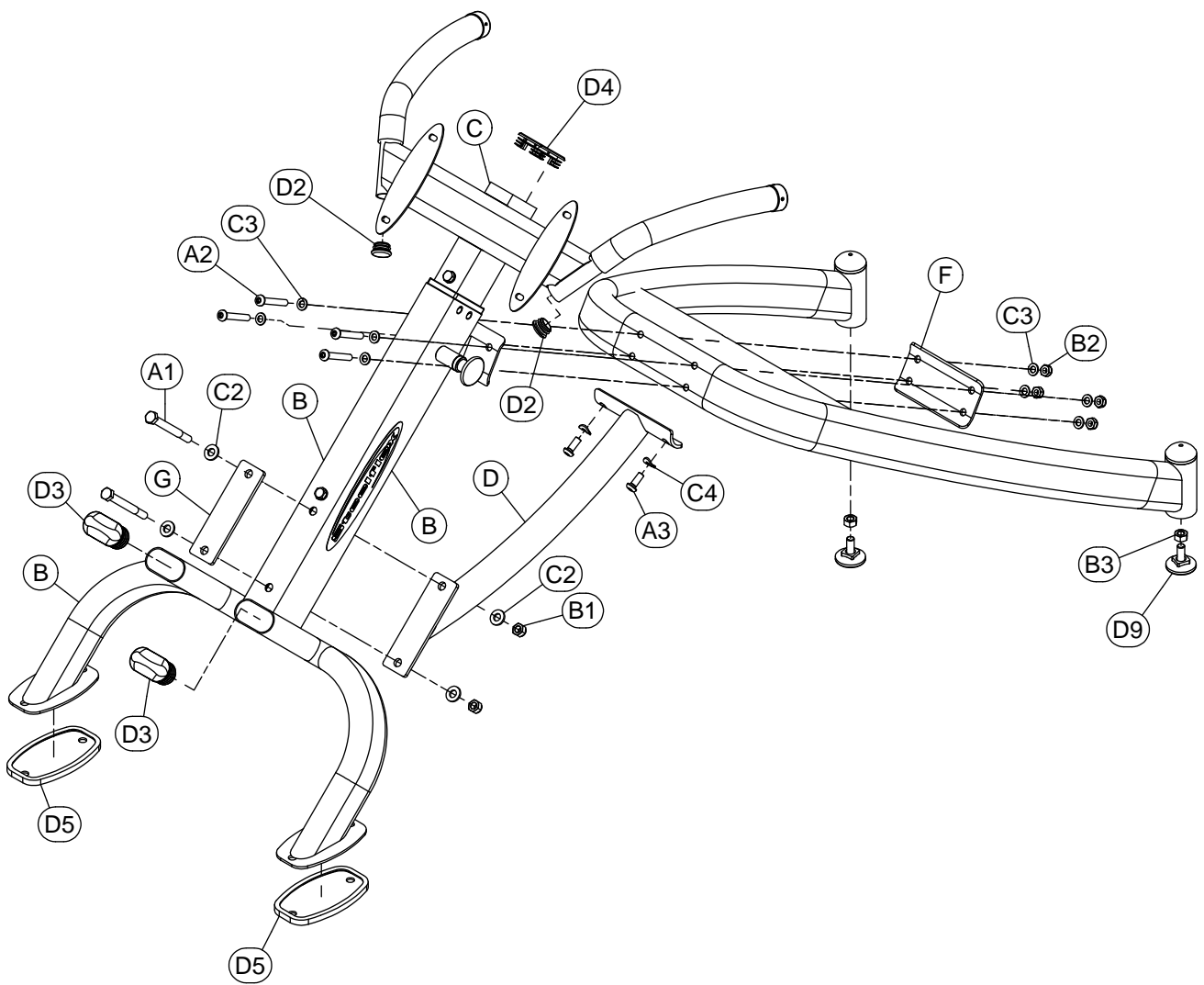
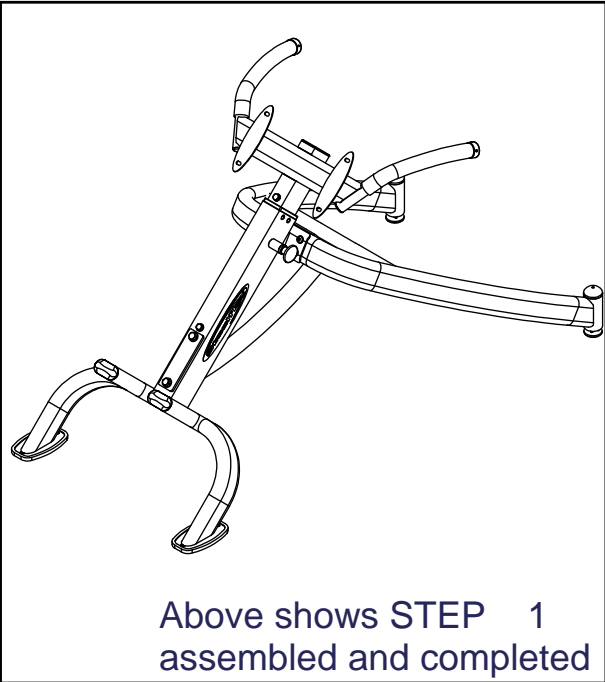

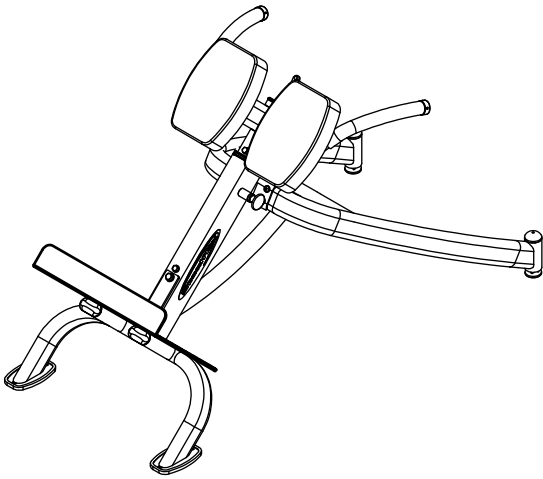

Above shows STEP 2 assembled and completed

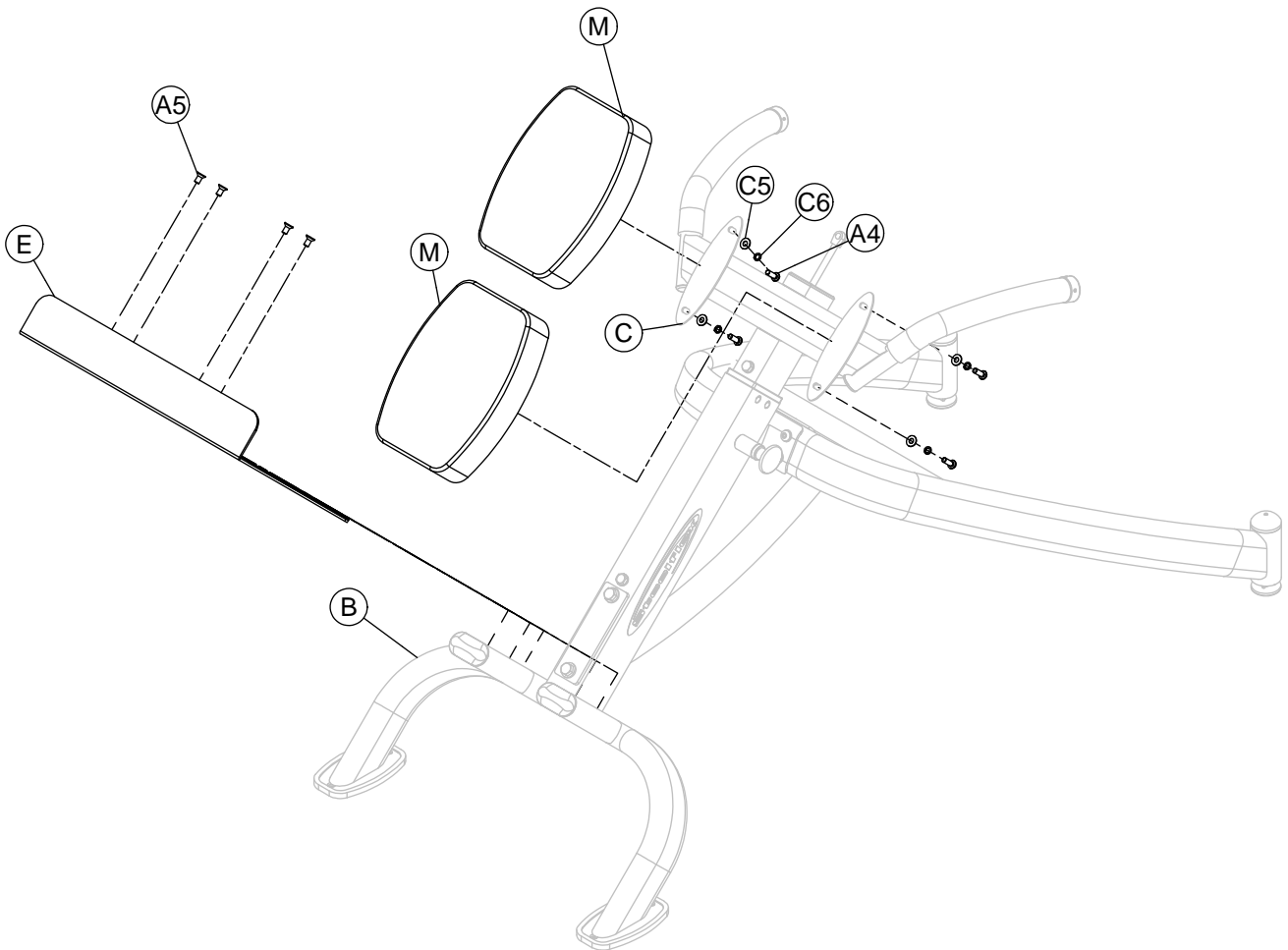

# NBE.5

