

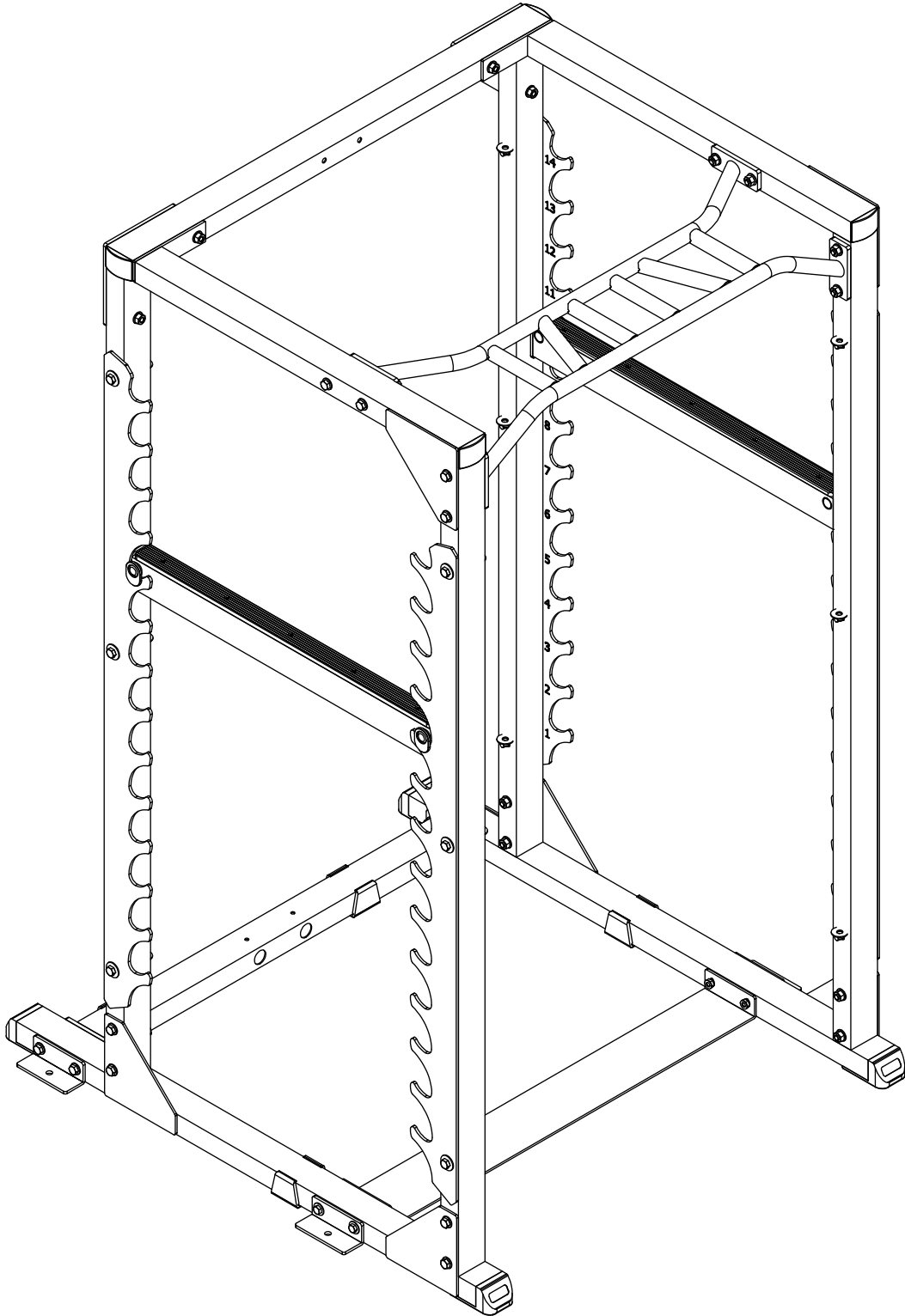

CLPR380



Assembly & Instructions
OWNER'S & MANUAL

CLPR-380 HARDWARE
(shown in actual size)

A1.M12X110L HEX HEAD BOLT-----[8PCS]

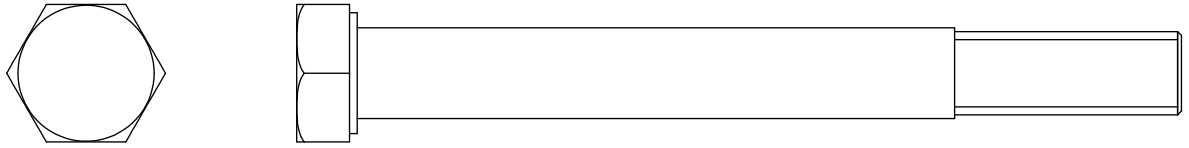

A2.M12X75L HEX HEAD BOLT-----[4PCS]

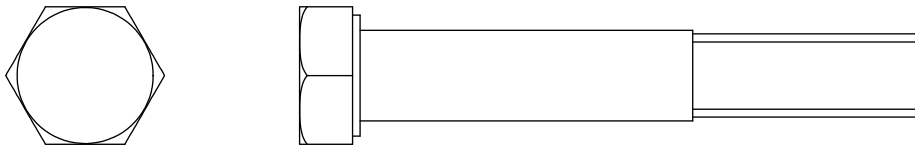

A3.M12X105L HEX HEAD BOLT-----[8PCS]

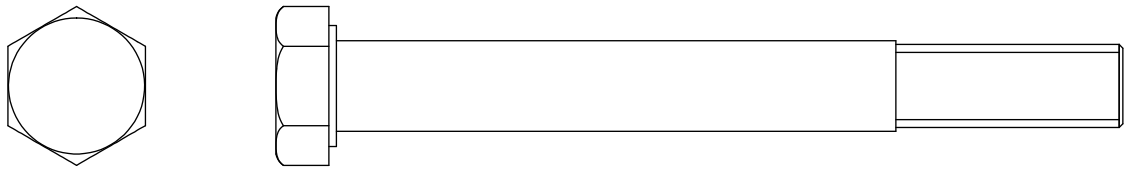

A4.M12X100L HEX HEAD BOLT-----[20PCS]

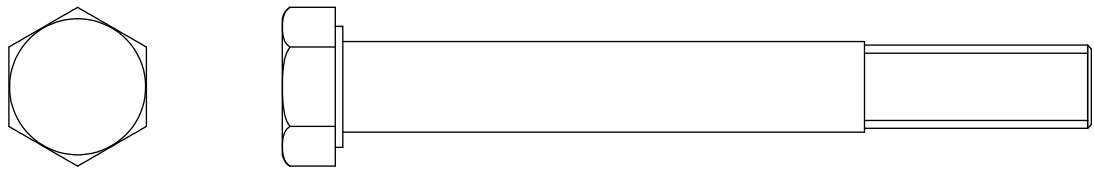

A5.M10X100L HEX HEAD BOLT-----[4PCS]

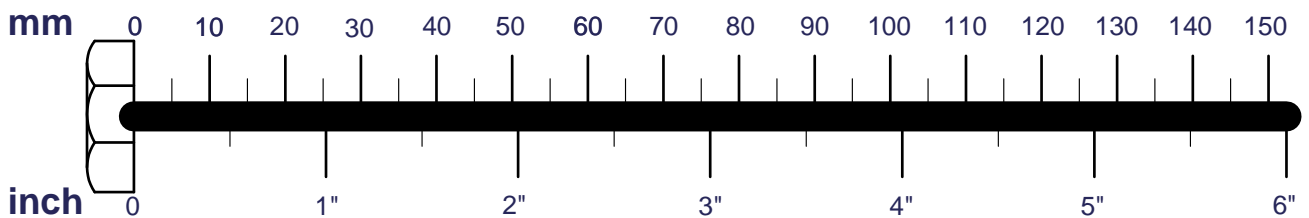
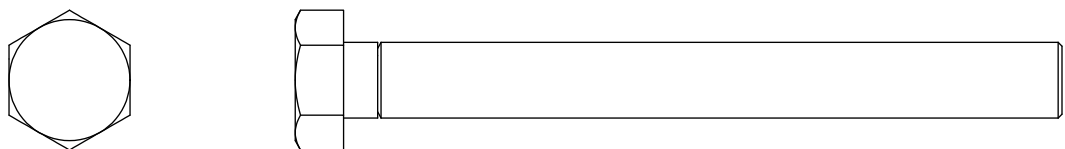

CLPR-380 HARDWARE
(shown in actual size)

A6.M5X15L TAPER SCREW (pre-installed)-----[10PCS]

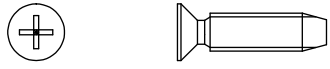

B1.M12 NYLON LOCK NUT-----[38PCS]

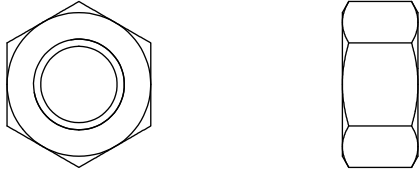

B2.M10 NYLON LOCK NUT-----[4PCS]

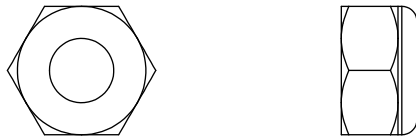

C1.M12 (Ø25) WASHER-----[78PCS]

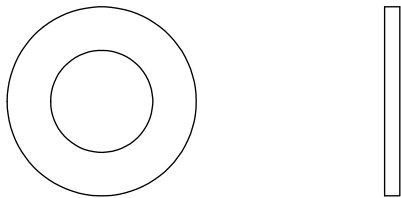

C2.M10 (Ø28) WASHER-----[8PCS]

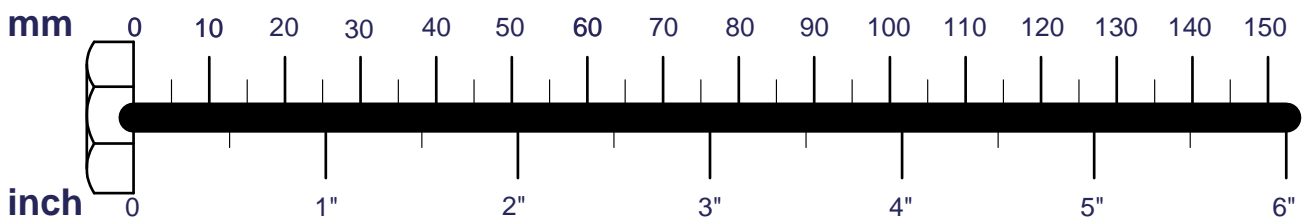
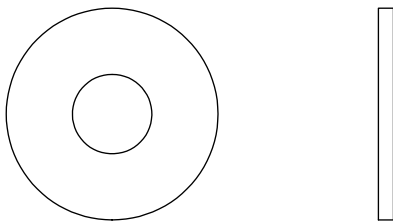

CLPR-380 HARDWARE (shown in actual size)

A [1PCS]

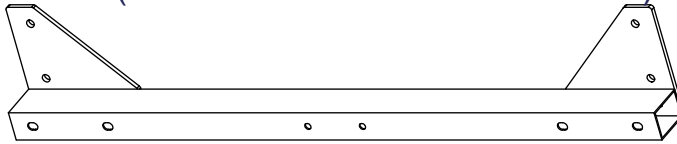

B [2PCS]
(10CLPR380-01)

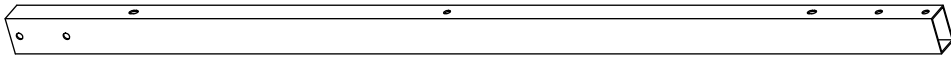

P [2PCS]
(10CLPR380-03)

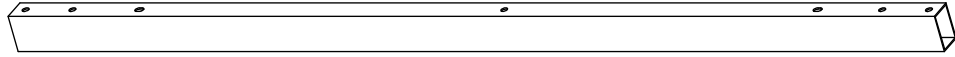

C [1PCS]

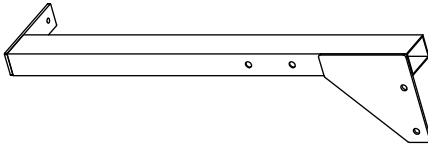

L [1PCS]

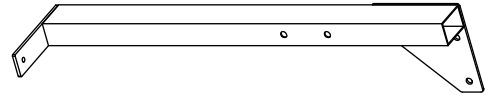

D [2PCS]

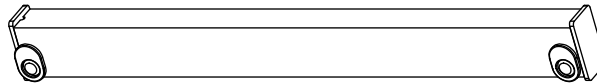

E [1PCS]

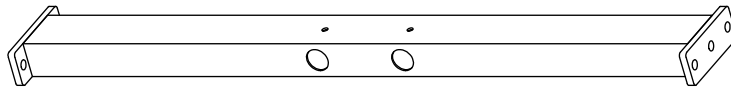

F [1PCS]

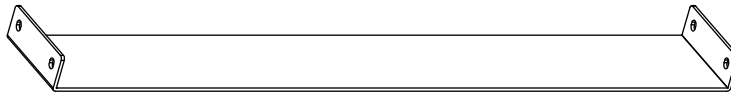

GL [2PCS]

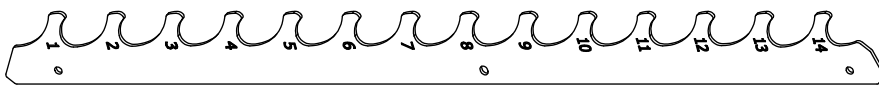

GR [2PCS]



H [1PCS]

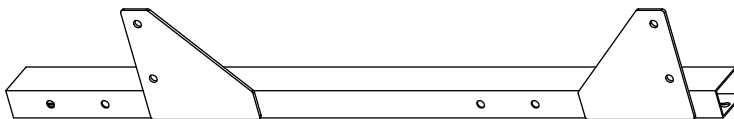

K [1PCS]

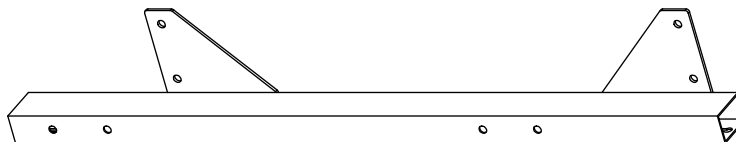

M [1PCS]

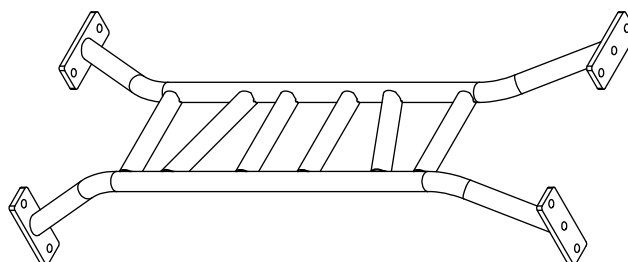

I [4PCS]
(8333-170)

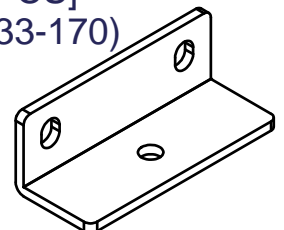

CLPR-380 HARDWARE
(shown in actual size)

- D1.END CAP (9211-084)-----[4PCS]
- D2.END CAP (9211-026)-----[4PCS]
- D3.RUBBER PAD (9310-130)(pre-installed)-----[2PCS]
- D4.RUBBER DOUNT (9212-011)-----[4PCS]

D1

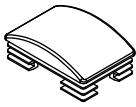

D2

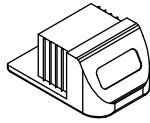

D3

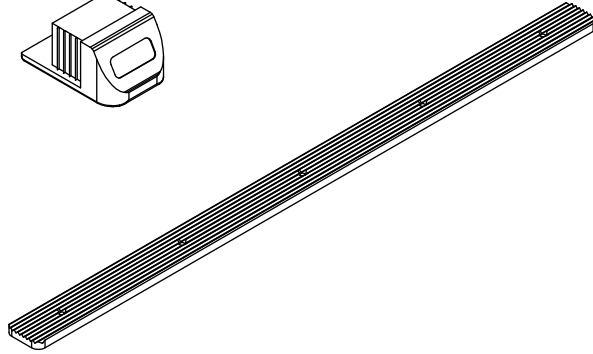

D4

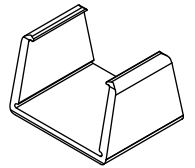

Above shows STEP 1 assembled and completed

Digital inside X4

